

new >>

G24, GX24 flush-mount lampholders
 Casing: PBT GF, white, T140 (acc. to IEC)
 Nominal rating: 660W/600V
 Quick-connect twin terminals: 18AWG (lamp circuit)
 For G24q, GX24q lampholders:
 quick-connect terminals: 18AWG (starter circuit)
 Base mounting holes for self-tapping #8 screws
 Base oblong holes for #8 screws (M4)
 Rear mounting holes for self-tapping #4 screws
 and for holes for self-tapping #8 screws
 Front mounting holes for #4 screws (M3)

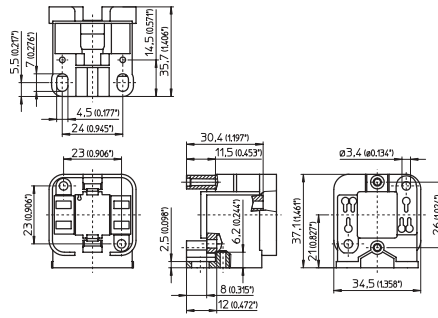

Type	Ref. No.	Base	Output (W)	Weight (g)	Packing qty. (pcs.)	
new >>	71701	527790	G24d-1/GX24d-1	8, 10, 13 / 13	13.2	500
new >>	71702	527791	G24d-2/GX24d-2	18 / 18	13.2	500
new >>	71703	527792	G24d-3/GX24d-3	26 / 26	13.2	500
new >>	71711	527794	G24q-1/GX24q-1	10, 13 / 13	15.2	500
new >>	71712	527795	G24q-2/GX24q-2	18 / 18	15.2	500
new >>	71713	527796	G24q-3/GX24q-3	26 / 26, 32	15.2	500
new >>	71719	527800	GX24q-3/-4*	26, 32 / 42	15.2	500
new >>	71714	527797	GX24q-4	42	15.2	500
new >>	71715	527798	GX24q-5	57	15.8	500
new >>	71716	527799	GX24q-6	70	15.8	500
Shunted Version						
new >>	71711	527802	G24q-1/GX24q-1	10, 13 / 13	15.2	500
new >>	71712	527803	G24q-2/GX24q-2	18 / 18	15.2	500
new >>	71713	527804	G24q-3/GX24q-3	26 / 26, 32	15.2	500
new >>	71719	527020	GX24q-3/-4*	26, 32 / 42	15.2	500
new >>	71714	527017	GX24q-4	42	15.2	500
new >>	71715	527018	GX24q-5	57	15.8	500
new >>	71716	527019	GX24q-6	70	15.8	500

* Lampholders 527800 and 527020 may only be used in luminaires that are operated with electronic ballasts that have been certified according to the applicable standards and that cover the luminaire performance range of 26, 32 and 42W.